



**BETTER**  
Homes & Developments



We take your dream  
and help make it a reality

## KINGSTON 273

Contemporary Façade

To find out more  
about this property  
**Dayne Molony: 0414 350 873**  
(02) 6584 7752

### KEY FEATURES

- ✓ A great design for blocks that slope up from the street with the downstairs ensuite bedroom having a number of potential uses, whether it be for guests, teenagers or to run a home business.
- ✓ The living and dining is very much open plan and well connected to the alfresco and front deck, with the kitchen featuring generous bench space and walk in pantry storage.
- ✓ The secluded master suite in this home is huge while the other bedrooms benefit from an adjoining activity or rumpus room.
- ✓ Perfect family home for all ages.



4



3



2

**A:** Suite 1 No 2 Murray Street, Port Macquarie NSW 2444

**P:** (02) 6584 7752

**E:** sales@betterhomes.com.au

[betterhomes.com.au](http://betterhomes.com.au)

© Better Homes

# KINGSTON 273



4



3



2

## UPPER FLOOR



## FLOOR PLAN DIMENSIONS

Length: 19.18m

Width: 13.48m

Total Size: 273.1m<sup>2</sup>

## LOWER FLOOR

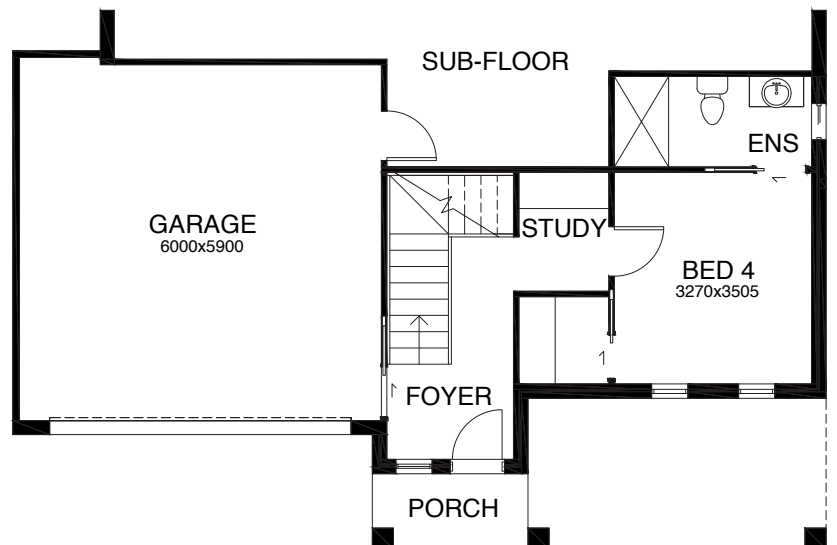

To find out more about this property  
**Dayne Molony: 0414 350 873**  
(02) 6584 7752

[betterhomes.com.au](https://www.betterhomes.com.au)

© Better Homes